

I252 PARTS LIST

ROCKET 800

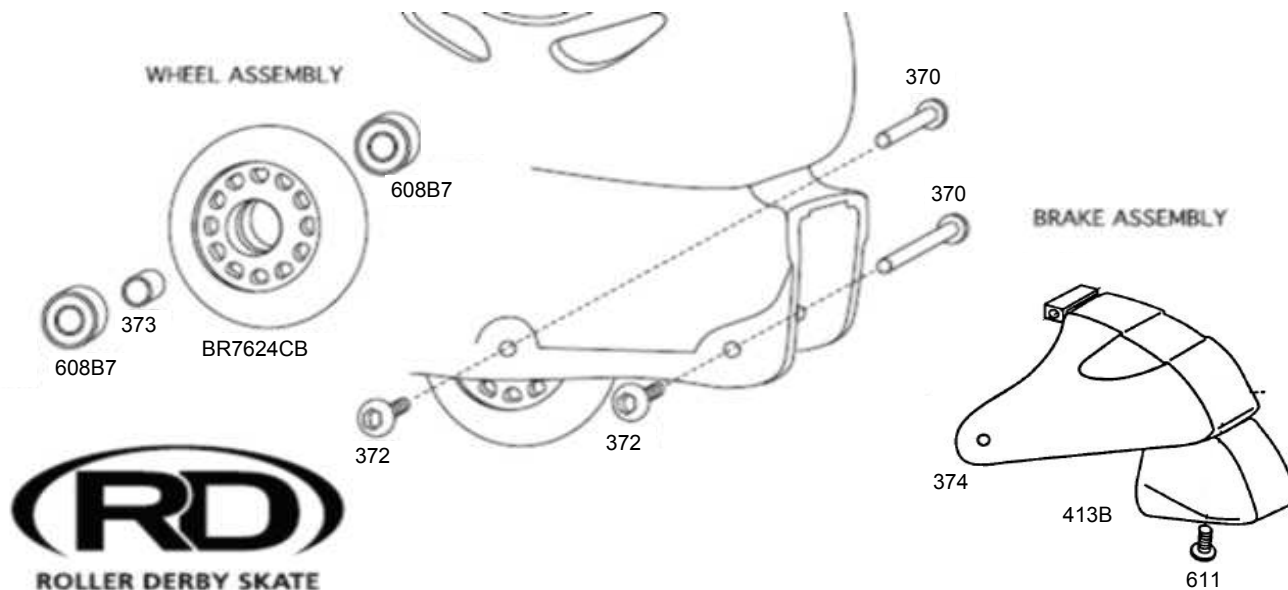

Part #	Description	Cost	Qty	Total	Part #	Description	Cost	Qty	Total
370	Female Axle 36mm	\$0.40			413B	Heel Stop Black	\$1.50		
370	Female Axle 36mm (Brake)	\$0.40			374	Heel Stop Bracket	\$1.50		
372	Male Axle Screw 12mm	\$0.40			3248L	Left Strap/Lever - Blk/Slvr	\$1.50		
BR7624CB	Wheel 76mm Clear	\$5.00			3248R	Right Strap/Lever - Blk/Slvr	\$1.50		
373	Bearing Spacer	\$0.40			2248C	Clip - Black	\$1.00		
611	Male Heel Stop Screw	\$0.40			2252	Liner - (Specify sz)	\$10.00		
608b7	Bearing - ABEC 7	\$2.00							
794	M/F Attaching Screws	\$0.25							

All orders must be paid by check, Visa, or Mastercard prior to shipment

All orders are required to be faxed or mailed with signature

CA residents add 8% tax
 IL residents add 7.25% tax
 PA residents add 6% tax

Subtotal	
Tax	
Shipping and Handling	\$6.25
TOTAL	

Name: _____ Signature: _____ Phone: _____

Address: _____ City: _____ State: _____ Zip: _____

MC or Visa #: _____ Exp Date: _____

1. Check the axle screws on each wheel. The male and female should be tightened firmly prior to each use.
2. Check heel stop screw before skating. The male and female should be tightened firmly. If heel stop shows substantial wear, it should be replaced.

1. Prüfen sie die schrauben aller rollen, schraube und mutter vor gebrauch gut festdrehen.
2. Prüfen sie die schraube beim stopper bevor sie fahren. Schraube und mutter gut befestigen. Ersetzen sie den stopper, wenn er abgenutzt ist.

1. Sur chaque roue, vérifiez les vis de l'essieu. Les vis males et femelles doivent être serrées fermement avant l'utilisation des patins.
2. Vérifiez les vis du frein avant l'utilisation des patins. Les vis males et femelles doivent être serrées fermement. Si le frein arriere montre des signes apparents d'usure. Veuillez le remplacer.

1. Cheque los tornillos de cada rueda, macho y hembra de los tornillos deberan apretarse antes de cada uso.
2. Cheque todos los tornillos del freno para asegurarse que esten bien apretados. Si nota que la goma del freno esta gastada, esta debera ser reemplazada por una nueva