

I-248/I-348 PARTS LIST

V500 Adjustable (6-9)

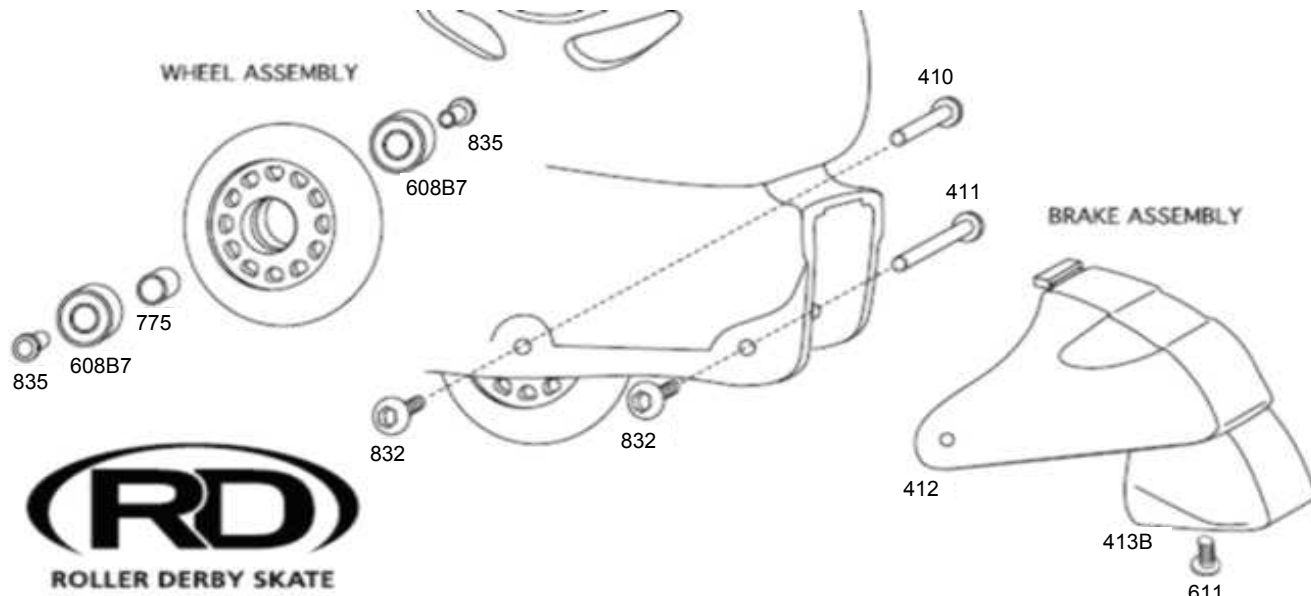

Part #	Description	Cost	Qty	Total	Part #	Description	Cost	Qty	Total
410	Female Axle	\$0.40			BF7678YW	Wheel - 76mm Yellow	\$6.00		
832	Male Axle Screw	\$0.40			3248L	Strap/Lever Left	\$1.50		
835	Bearing Alignment Insert	\$0.40			3248R	Strap/Lever Right	\$1.50		
775	Bearing Spacer	\$0.20			2248C	Clip - Clear	\$1.00		
608B7	Bearing - ABEC 9	\$2.00			2348L	Liner - I348	\$10.00		
611	Male Heel Stop Screw	\$0.40			2248L	Liner - I248	\$10.00		
411	Female Axle (Brake)	\$0.40			413B	Heel Stop - Black	\$1.50		
BF7678PW	Wheel - 76mm Purple	\$6.00			412	Heel Stop Bracket	\$1.50		

All orders must be paid by check, Visa, or Mastercard prior to shipment

All orders are required to be faxed or mailed with signature

CA residents add 8% tax
 IL residents add 7.25% tax
 PA residents add 6% tax

Subtotal	
Tax	
Shipping and Handling	\$6.25
TOTAL	

Name: _____ Signature: _____ Phone: _____

Address: _____ City: _____ State: _____ Zip: _____

MC or Visa #: _____ Exp Date: _____

1. Check the axle screws on each wheel. The male and female should be tightened firmly prior to each use.
 2. Check heel stop screw before skating. The male and female should be tightened firmly. If heel stop shows substantial wear, it should be replaced.
1. Sur chaque roue, vérifiez les vis de l'essieu. Les vis mâles et femelles doivent être serrées fermement avant l'utilisation des patins.
 2. Vérifiez les vis du frein avant l'utilisation des patins. Les vis mâles et femelles doivent être serrées fermement. Si le frein arrière montre des signes apparents d'usure. Veuillez le remplacer.

1. Prüfen sie die schrauben aller rollen, schraube und mutter vor gebrauch gut festdrehen.
 2. Prüfen sie die schraube beim stopper bevor sie fahren. Schraube und mutter gut befestigen. Ersetzen sie den stopper, wenn er abgenutzt ist.
1. Cheque los tornillos de cada rueda, macho y hembra de los tornillos deberan apretarse antes de cada uso.
 2. Cheque todos los tornillos del freno para asegurarse que esten bien apretados. Si nota que la goma del freno esta gastada, esta debera ser reemplazada por una nueva