

# I-234 / I-334 PARTS LIST

# QE747

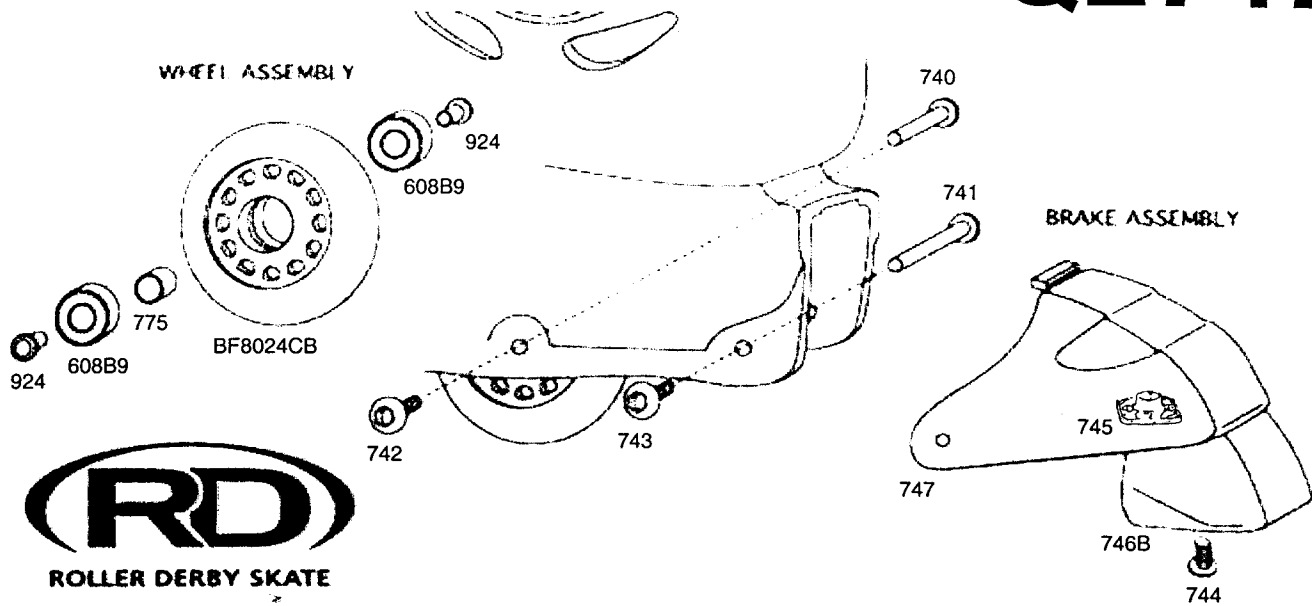

Part #	Description	Cost	Qty	Total	Part #	Description	Cost	Qty	Total
740	Female Axle 33mm	\$0.40			745	Female Heel Stop Insert	\$0.40		
741	Female Axle 45mm (Brake)	\$0.40			746B	Heel Stop - Black	\$1.50		
742	Male Axle Screw 14mm	\$0.40			747	Heel Stop Bracket	\$1.50		
743	Male Axle 15mm (Brake)	\$0.40			3234	Strap/Lever - Black	\$1.50		
924	Bearing Alignment Insert	\$0.40			3334	Clip - Black	\$1.00		
775	Bearing Spacer	\$0.20			2234	Liner - Men's (Specify sz)	\$10.00		
608B9	Bearing - ABEC 9	\$2.50			2334	Liner - Wmn's (Specify sz)	\$10.00		
744	Male Heel Stop Screw 33mm	\$0.40			BF8024CB	Wheel - 80mm RX Formula	\$4.00		

All orders must be paid by check, Visa, or Mastercard prior to shipment

All orders are required to be faxed or mailed with signature

CA residents add 8.25% tax

IL residents add 6.75% tax

PA residents add 6% tax

Subtotal

Tax

Shipping and Handling

\$6.25

TOTAL

Name: \_\_\_\_\_ Signature: \_\_\_\_\_ Phone: \_\_\_\_\_

Address: \_\_\_\_\_ City: \_\_\_\_\_ State: \_\_\_\_\_ Zip: \_\_\_\_\_

MC or Visa #: \_\_\_\_\_ Exp Date: \_\_\_\_\_

1. Check the axle screws on each wheel. The male and female should be tightened firmly prior to each use.
2. Check heel stop screw before skating. The male and female should be tightened firmly. If heel stop shows substantial wear, it should be replaced.
1. Sur chaque roue, vérifiez les vis de l'essieu. Les vis mâles et femelles doivent être serrées fermement avant l'utilisation des patins.
2. Vérifiez les vis du frein avant l'utilisation des patins. Les vis mâles et femelles doivent être serrées fermement. Si le frein arrière montre des signes apparents d'usure. Veuillez le remplacer.

1. Prüfen sie die schrauben aller rollen, schraube und mutter vor gebrauch gut festdrehen.
2. Prüfen sie die schraube beim stopper bevor sie fahren. Schraube und mutter gut befestigen. Ersetzen sie den stopper, wenn er abgenutzt ist.
1. Cheque los tornillos de cada rueda, macho y hembra de los tornillos deberan apretarse antes de cada uso.
2. Cheque todos los tornillos del freno para asegurarse que esten bien apretados. Si nota que la goma del freno esta gastada, esta debera ser reemplazada por una nueva