

I-143B/I-143G PARTS LIST

Hornet Adjustable

Small sz 12-2 64 mm
Medium sz 2-5 70 mm

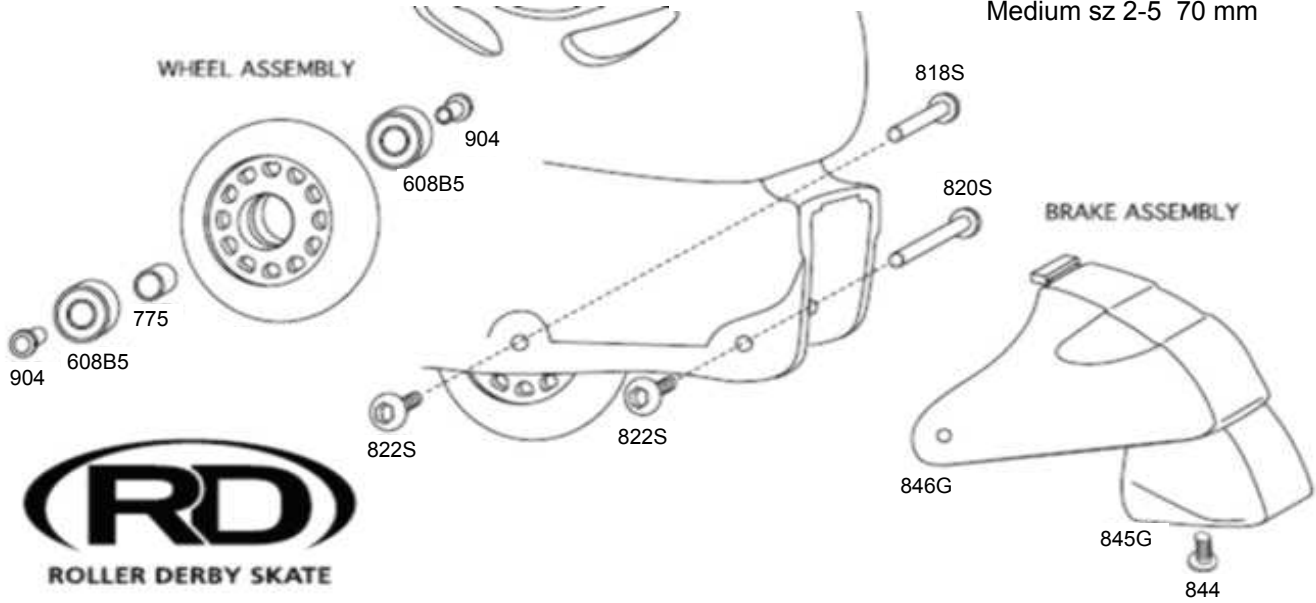

Part #	Description	Cost	Qty	Total	Part #	Description	Cost	Qty	Total
818S	Female Axle 32mm	\$0.40			3143P	Strap/Lever Pink/Wht	\$1.50		
822S	Male Axle Screw 10 mm	\$0.40			3143O	Strap/Lever Orange/Black	\$1.50		
904	Bearing Alignment Insert	\$0.40			3442B	Clip - Black	\$1.00		
775	Bearing Spacer	\$0.20			845G	Heel Stop - Gray	\$1.50		
608B5	Bearing - ABEC 5	\$2.00			846G	Heel Stop Bracket	\$1.50		
844	Male Heel Stop Screw	\$0.40			BF7082PK	Med Wheel - 70mm Pink	\$5.00		
820S	Female Axle (Brake)	\$0.40			BF7082OR	Med Wheel - 70mm Orange	\$5.00		
BF6482PK	Small Wheel - 64mm Pink	\$4.00							
BF6482OR	Small Wheel - 64mm Orang	\$4.00							

All orders must be paid by check, Visa, or Mastercard prior to shipment
All orders are required to be faxed or mailed with signature

CA residents add 8% tax
IL residents add 7.25% tax
PA residents add 6% tax

Subtotal	
Tax	
Shipping and Handling	\$6.25
TOTAL	

Name: _____ Signature: _____ Phone: _____

Address: _____ City: _____ State: _____ Zip: _____

MC or Visa #: _____ Exp Date: _____

1. Check the axle screws on each wheel. The male and female should be tightened firmly prior to each use.
2. Check heel stop screw before skating. The male and female should be tightened firmly. If heel stop shows substantial wear, it should be replaced.

1. Prüfen sie die schrauben aller rollen, schraube und mutter vor gebrauch gut festdrehen.
2. Prüfen sie die schraube beim stopper bevor sie fahren. Schraube und mutter gut befestigen. Ersetzen sie den stopper, wenn er abgenutzt ist.

1. Sur chaque roue, vérifiez les vis de l'essieu. Les vis males et femelles doivent être serrées fermement avant l'utilisation des patins.
2. Vérifiez les vis du frein avant l'utilisation des patins. Les vis males et femelles doivent être serrées fermement. Si le frein arriere montre des signes apparents d'usure. Veuillez le remplacer.

1. Cheque los tornillos de cada rueda, macho y hembra de los tornillos deberan apretarse antes de cada uso.
2. Cheque todos los tornillos del freno para asegurarse que esten bien apretados. Si nota que la goma del freno esta gastada, esta debera ser reemplazada por una nueva