

I-139B/I-139G PARTS LIST

Cobra Adjustable

Small sz 12-1
Medium sz 2-5

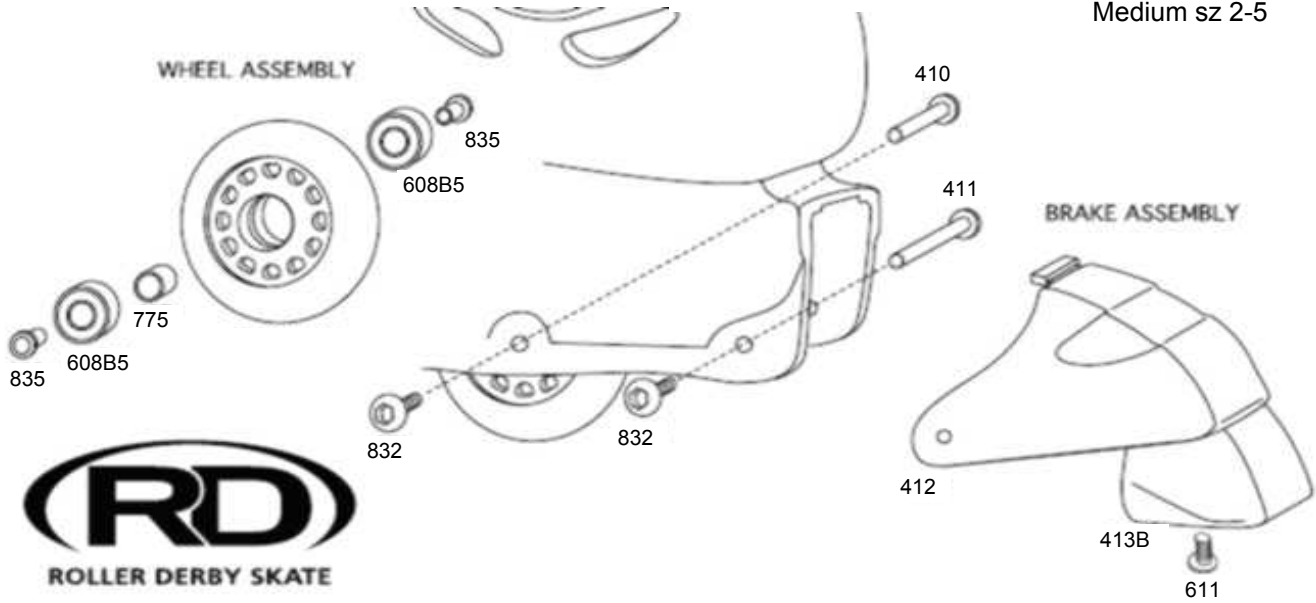

Part #	Description	Cost	Qty	Total	Part #	Description	Cost	Qty	Total
410	Female Axle	\$0.40			3248L	Strap/Lever Left	\$1.50		
832	Male Axle Screw	\$0.40			3248R	Strap/Lever Right	\$1.50		
835	Bearing Alignment Insert	\$0.40			2248C	Clip - Clear	\$1.00		
775	Bearing Spacer	\$0.20			2239B	Liner - Black S or M	\$10.00		
608B5	Bearing - ABEC 5	\$2.00			2239G	Liner - Gray S or M	\$10.00		
611	Male Heel Stop Screw	\$0.40			413B	Heel Stop - Black	\$1.50		
411	Female Axle (Brake)	\$0.40			412	Heel Stop Bracket	\$1.50		
BF6424BW	Small Wheel - 64mm Black	\$4.00			BF7224BW	Med Wheel - 72mm Black	\$5.00		
BF6424PW	Small Wheel - 64mm Purple	\$4.00			BF7224PW	Med Wheel - 72mm Purple	\$5.00		

All orders must be paid by check, Visa, or Mastercard prior to shipment
All orders are required to be faxed or mailed with signature

CA residents add 8% tax
IL residents add 7.25% tax
PA residents add 6% tax

Subtotal	
Tax	
Shipping and Handling	\$6.25
TOTAL	

Name: _____ Signature: _____ Phone: _____

Address: _____ City: _____ State: _____ Zip: _____

MC or Visa #: _____ Exp Date: _____

1. Check the axle screws on each wheel. The male and female should be tightened firmly prior to each use.
2. Check heel stop screw before skating. The male and female should be tightened firmly. If heel stop shows substantial wear, it should be replaced.

1. Prüfen sie die schrauben aller rollen, schraube und mutter vor gebrauch gut festdrehen.
2. Prüfen sie die schraube beim stopper bevor sie fahren. Schraube und mutter gut befestigen. Ersetzen sie den stopper, wenn er abgenutzt ist.

1. Sur chaque roue, vérifiez les vis de l'essieu. Les vis males et femelles doivent être serrées fermement avant l'utilisation des patins.
2. Vérifiez les vis du frein avant l'utilisation des patins. Les vis males et femelles doivent être serrées fermement. Si le frein arriere montre des signes apparents d'usure. Veuillez le remplacer.

1. Cheque los tornillos de cada rueda, macho y hembra de los tornillos deberan apretarse antes de cada uso.
2. Cheque todos los tornillos del freno para asegurarse que esten bien apretados. Si nota que la goma del freno esta gastada, esta debera ser reemplazada por una nueva